

HardieWall™ System - Intermediate Joint

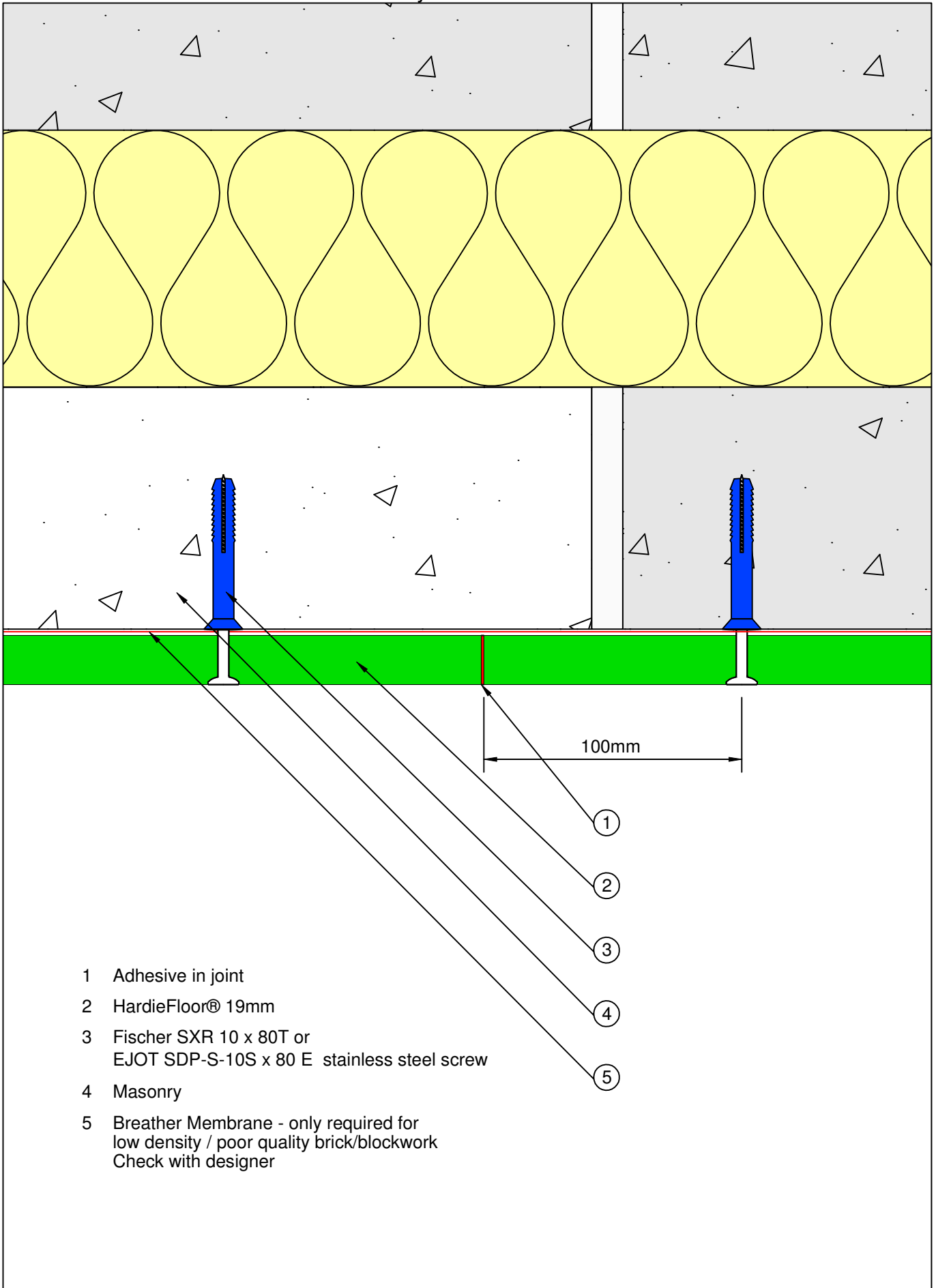

- 1 Adhesive in joint
- 2 HardieFloor@ 19mm
- 3 Fischer SXR 10 x 80T or EJOT SDP-S-10S x 80 E stainless steel screw
- 4 Masonry
- 5 Breather Membrane - only required for low density / poor quality brick/blockwork
Check with designer