

# Hardiewall™ System - Vent Eaves Detail

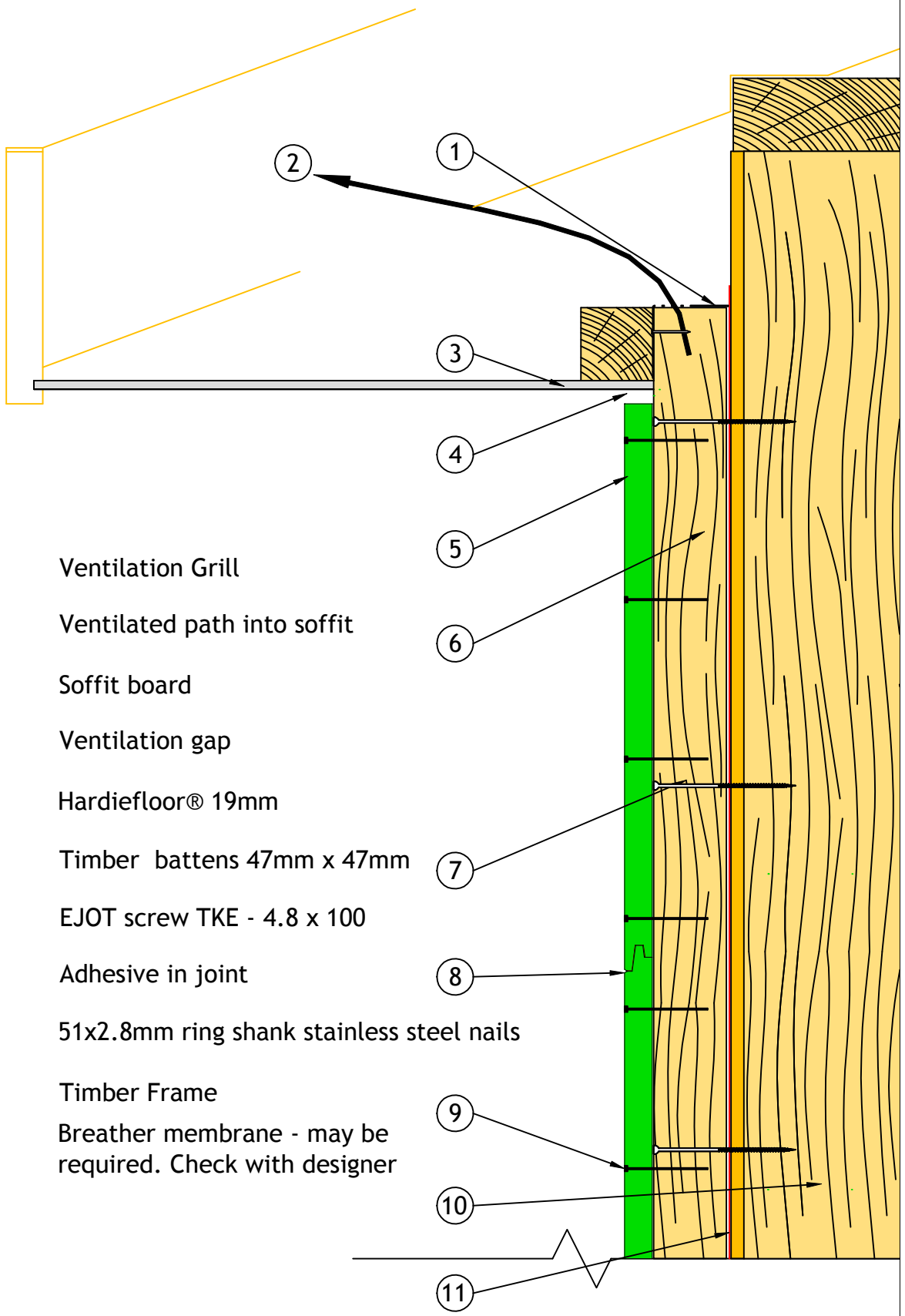

- 1 Ventilation Grill
- 2 Ventilated path into soffit
- 3 Soffit board
- 4 Ventilation gap
- 5 Hardiefloor® 19mm
- 6 Timber battens 47mm x 47mm
- 7 EJOT screw TKE - 4.8 x 100
- 8 Adhesive in joint
- 9 51x2.8mm ring shank stainless steel nails
- 10 Timber Frame
- 11 Breather membrane - may be required. Check with designer